



**BACE**  
BALER AND COMPACTION EQUIPMENT



## Vertical Baler: V73HD

This unit is 72" wide to accommodate larger or more lengthy boxes or other materials. This unit is ideal for audio or television boxes and other larger cardboard cartons.

Call Today: (877) 506-BACE  
or visit us online at [bacecorp.com](http://bacecorp.com)

322 West 32nd Street  
Charlotte, NC. 28206

### Ideal For:

- Grocery Stores
- Home Retailers
- Pharmacies
- Big Box Retailers
- National Accounts
- Commissaries
- Warehouses
- Distribution Centers
- Hospitals, Schools & Universities
- Recyclers



Carolina  
Recycling  
Association



BACE Vertical Balers meet or exceed all existing ANSI & OSHA Safety Standards and are totally 100% ETL & CETL Approved.



**BACE**  
BALER AND COMPACTION EQUIPMENT

10' 254mm  
24" / 610mm

**CED 1R00-B**

Call Today: (877) 506-BACE  
or visit us online at [bacecorp.com](http://bacecorp.com)

## Vertical Baler: V73HD

Our standard V73HD features a 10 HP High Efficiency-Power Unit.

Specifications	
Performance	
Nominal Bale Size	72" x 30" x 48"
Bale Weight	Up to 1300 lbs OCC
Bale Volume	60 cu. ft.
No. of Bale Tie Slots	7
Compact Force lbs - Based on Factory Set (psi)	62,203
Platen Pressure	28 PSI
Average Cycle Time	40 Seconds
Loading Height	49.50"
Ejector System	Semi-Automatic
Full Bale Light	Standard
Hydraulic / Electrical	
Motor HP	10
Voltage 3 Phase	208V, 230V, 480V
Full Load Amps (A = Amps)	32A, 28A, 14A
Pump GPM	15
Factory Set System Pressure PSI	2200
Cylinder Bore x Stroke	6" x 48"
Hydraulic Tank-Capacity Gallons	22
ADDITIONAL HYDRAULIC/ELECTRICAL CONFIGURATIONS ARE AVAILABLE. PLEASE CALL BACE FOR MORE INFORMATION.	

**Available Options:**

- Slotted Front Door
- Wire Guides (allows for front bale tie-off)
- Rear Feed Opening, Front Eject
- Feed Chute
- Counter Weighted Floppy Retainer Dogs
- Oil Heater
- Weather Proof Package

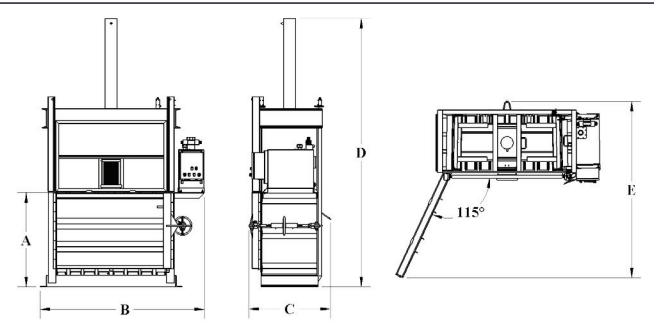

DIM. (in./mm)	A	B	C	D	E
V73HD	49.5/1257	99/2515	43/1092	141.5/3594	104/2642

Due to continual product improvement BACE reserves the right to change specifications without notice.  
The information and pictures used in the document are for illustrative purposes only. Printed on recycled paper. January 2017



**BACE**  
BALER AND COMPACTION EQUIPMENT

10' / 254mm  
24" / 610mm

**CED 1R00-B**

Call Today: (877) 506-BACE  
or visit us online at [bacecorp.com](http://bacecorp.com)

## Customer Order Form: V73HD

Bill To	Ship To
Company: (Legal Name)	Company: (Legal Name)
Address:	Address:
City / State / Zip:	City / State / Zip:
Attention:	Attention:
Phone:	Phone:
Fax:	Fax:

## Order Details

### Select HP / Voltage and Electrical Requirements - Standard Power Unit(s)

	Motor HP	Voltage	Full Load Amps	Power Supply Required
<input type="radio"/>	10HP-SUB-3PH	208V	32	60
<input type="radio"/>	10HP-SUB-3PH	230V	28	60
<input type="radio"/>	10HP-SUB-3PH	460/480V	14	30

Customer is required to supply a fused disconnect and 12' pigtail

<input type="checkbox"/>	Paid Options - Call for Pricing	Choose Door Swing - Drawing shows LEFT HAND												
<input type="checkbox"/>	Optional Power _____ V _____ HZ _____ PHASE	layout based on side of hinge when facing the baler.												
<input type="checkbox"/>	Slotted Door													
<input type="checkbox"/>	Single Phase Power Unit	<input type="radio"/> LEFT HAND HINGE <input type="radio"/> RIGHT HAND HINGE												
<input type="checkbox"/>	Rear Wire Guides													
<input type="checkbox"/>	Rear Feed Front Eject													
<input type="checkbox"/>	Front Feed Chute													
<input type="checkbox"/>	Floppy Retainer Dogs													
<input type="checkbox"/>	Oil Heater													
<input type="checkbox"/>	Weather Proof (outdoor use)													
<input type="checkbox"/>	Wire (\$90 per bundle) #													
<input type="checkbox"/>	Custom Color / Color Code:													
<input type="checkbox"/>	Custom Logo / No charge													
<input type="checkbox"/>	Standard Colors / No Charge <input type="checkbox"/> Gray <input type="checkbox"/> Green <input type="checkbox"/> Blue													
		<table border="1"> <thead> <tr> <th>DIM. (in./mm)</th> <th>A</th> <th>B</th> <th>C</th> <th>D</th> <th>E</th> </tr> </thead> <tbody> <tr> <td>V73HD</td> <td>49.5/1257</td> <td>99/2515</td> <td>43/1092</td> <td>141.5/3594</td> <td>104/2642</td> </tr> </tbody> </table>	DIM. (in./mm)	A	B	C	D	E	V73HD	49.5/1257	99/2515	43/1092	141.5/3594	104/2642
DIM. (in./mm)	A	B	C	D	E									
V73HD	49.5/1257	99/2515	43/1092	141.5/3594	104/2642									

DELIVERY DETAILS (If you require BACE to setup installation, please fill out Page 4 of this document).

What is your required delivery date? \_\_\_\_/\_\_\_\_/\_\_\_\_ Do you require BACE to deliver?  YES  NO

To process this order, we must receive a signed copy of this document along with a signed copy of the Estimate from BACE for this job.

Signature: \_\_\_\_\_ Date: \_\_\_\_/\_\_\_\_/\_\_\_\_ P.O. # \_\_\_\_\_

Please fax to: 704-394-2210 or email to [SALES@BACECORP.COM](mailto:SALES@BACECORP.COM)



**BACE**  
BALER AND COMPACTION EQUIPMENT

**CED 1R00-B**

Call Today: (877) 506-BACE  
or visit us online at [bacecorp.com](http://bacecorp.com)

## Customer Installation Details

Contact Information	Installation Questions	
Company:	Do you have a loading dock with an 8' wide door?	<input type="radio"/> YES <input type="radio"/> NO
Address:	What is your ceiling height?	
	Any obstacles (steps, grade change, overhead pipes, etc)	<input type="radio"/> YES <input type="radio"/> NO
City / State / Zip:	Do we need to remove an existing baler?	<input type="radio"/> YES <input type="radio"/> NO
Attention:	Do you have a forklift on site? (If no, a \$350 forklift fee will apply)	<input type="radio"/> YES <input type="radio"/> NO
Phone:	What is the capacity of your forklift?	<input type="radio"/> YES <input type="radio"/> NO
Fax:		

Provide a diagram for the proposed location of the baler similar to the drawing below.

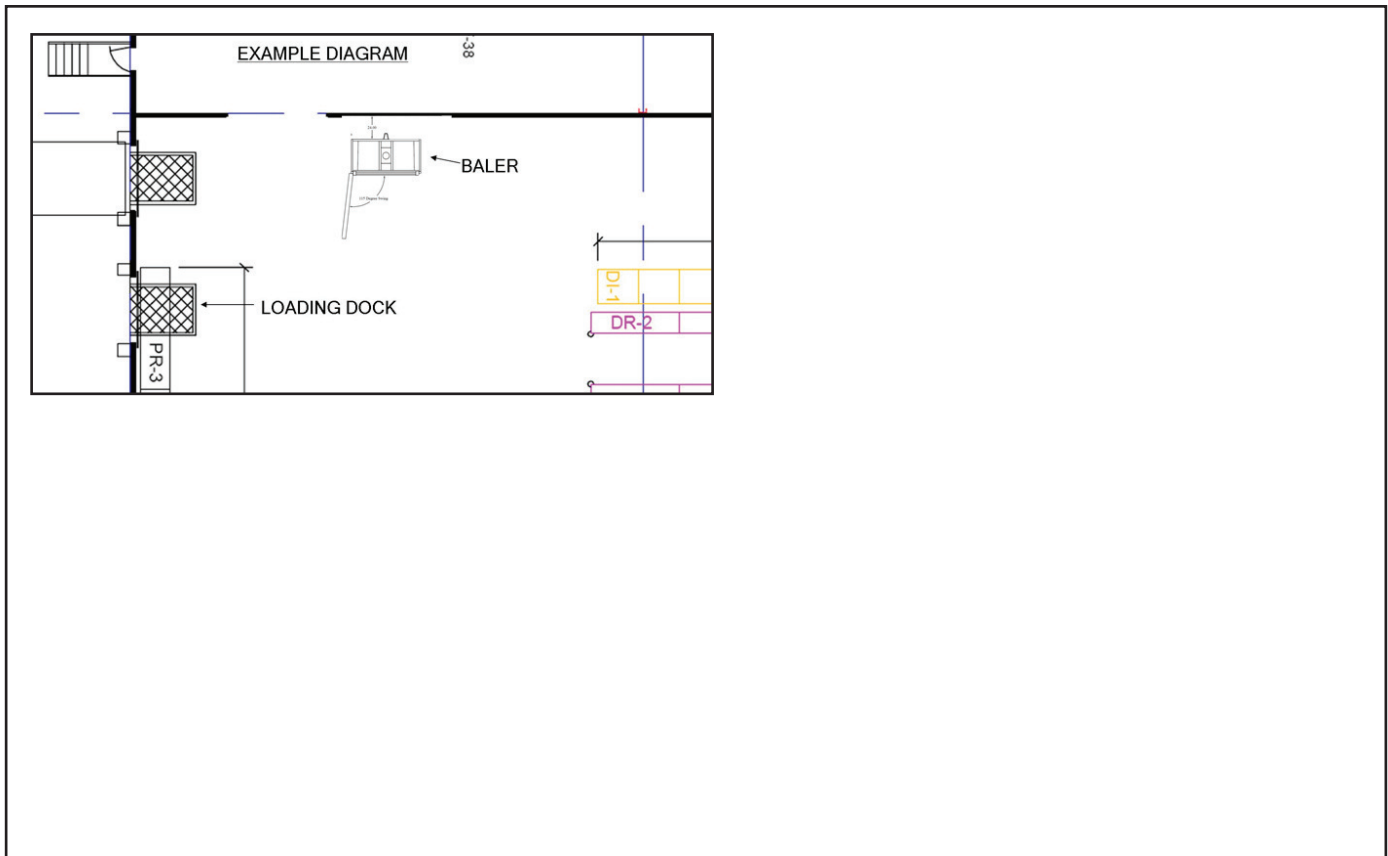

To process this order, we must receive a signed copy of this document along with a signed copy of the Estimate from BACE for this job.

Signature: \_\_\_\_\_ Date: \_\_\_\_/\_\_\_\_/\_\_\_\_ P.O. # \_\_\_\_\_

Please fax to: 704-394-2210 or email to [SALES@BACECORP.COM](mailto:SALES@BACECORP.COM)